

TIMBER FRAME WALLING ABOVE DPC (refer to elevations)
FRAMING - Stress graded BS 4978, Strength BS 5248 - Part 2 C16, Frame
 - 140mm x 50mm s/w studs @ 600mm centres, nailed to head & base plates.
 Double up studs at openings & corners & fit metal corner beads. Provide
 nogging staggered horizontally @ 600mm centres. Sheathing by Timber
 Frame.
INSULATION - F50y fill with 140mm Glass Fibre (BS5250) insulation
INTERNAL LINING - 10mm plywood sheathing lined with Pro Clima Intello
 Plus membrane. Seal overlaps between membrane with Pro Clima Tescon
 No.1 tape. Reveal timber battens 38x38mm @ max 900 c/c (service void)
 BATTENS - Reveal timber battens 38x38mm @ max 900 c/c (service void)
 lined with 12.5mm thick plasterboard & skim finish.
EXTERNAL LINING - External side of studs with 10mm sheathing board and
 breathable membrane (by Timber Frame Manufacturer)
ALLOW FOR SHIPPING AND INSTALLING A further 100mm Celotex G44100
 insulation board fixed through to timber frame subwork.
 Tape all joints of Celotex insulation boards.

Units - Use relevant sized timber frame bents, to have min end bearings
 500mm in all cases. Install cavity tray / damp proof protector over, with min
 upstand of 140mm returned to inner leaf & projecting at least 150mm
 beyond end of nail.

TIMBER BOARDING-VERTICAL & HORIZONTAL - Cladding to be:
Locally sourced Larch
 Volume: As detailed
 Size: 100x50mm - Length to suit. (Refer to details: Elevations)
 Treatment: F50y preservative treatment.
 Finish: F50y preservative treatment.

Vertical cladding to have 5mm gap between fixed to battens through Back
 breathable membrane.
 Horizontal cladding to have 5mm gap between fixed to battens through
 Back breathable membrane.

Battens to be 38x38mm treated softwood vertical, on to horizontal battens at
 450mm centres.
 Horizontal cladding to have 5mm gap between fixed to battens through
 Back breathable membrane.
 Battens to be 38x38mm treated softwood vertical at 450mm centres.

REFER TO DETAILS

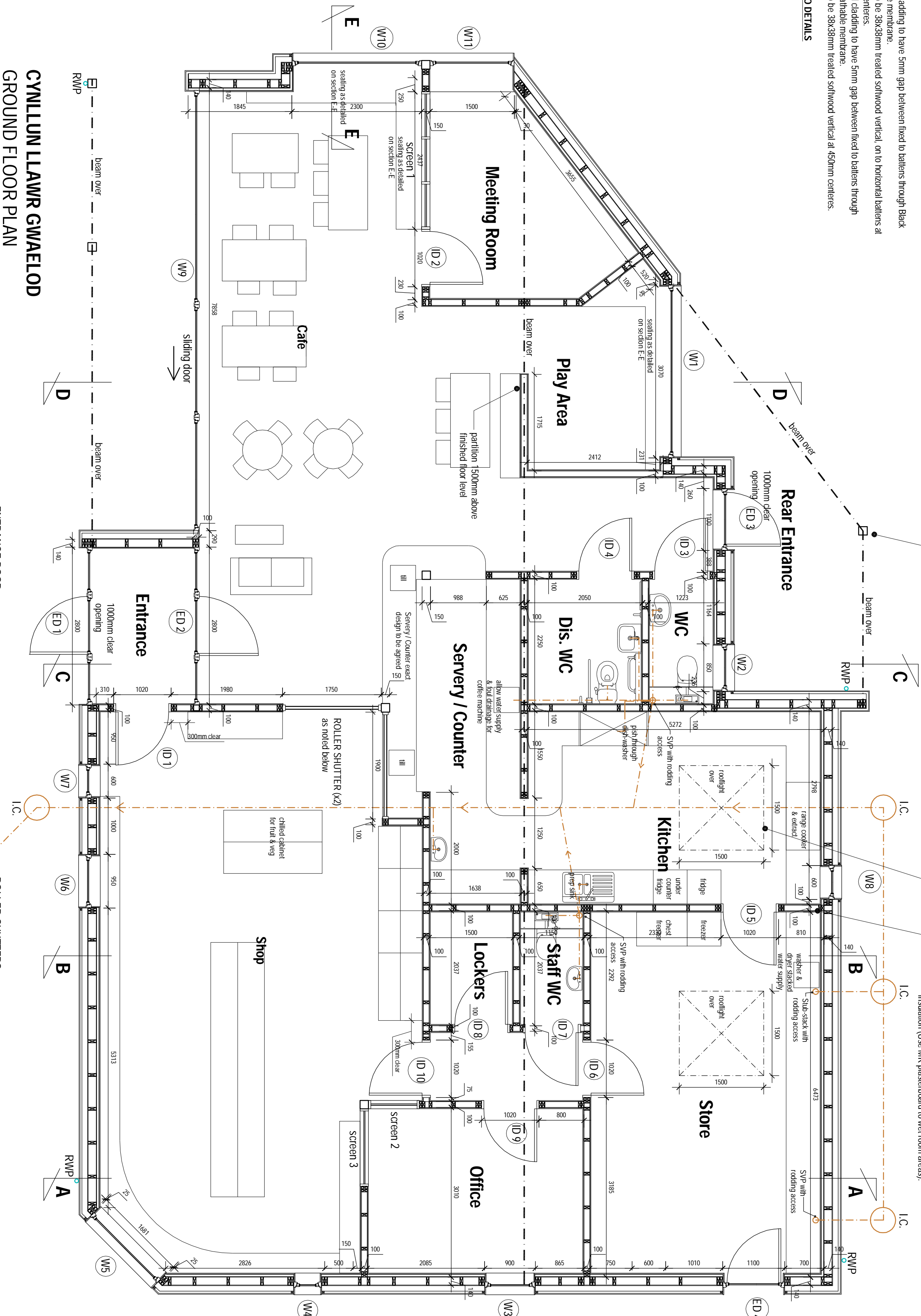

CYLLIUN LLAWR GWAELOD
GROUND FLOOR PLAN

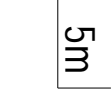

PART F
 A 5mm air gap is to be provided between the bottom of all internal doors and
 finished floor level.
BOXING
 All waste pipes on ground floor to be boxed in (as indicated on plan) using
 100x50mm treated C16 softwood framing, 12.5mm plasterboard and skim finish.

COLUMN
 Columns to be of timber bents, as designed by
 the manufacturer. Timber columns to be fixed to
 beam / wall plate that supports roof above.
 Timber columns to be fixed to T shape
 galvanised steel shoe, bolted down to
 masonry as shown. Refer to detail on drawing
 13 / 36 / 15

Timber frame manufacturer to be responsible
 for sizing all joists / beams etc. and forward
 calculations to building control officer for
 approval.

ROOFLIGHTS
 Allow for providing and installing flat roof light to area shown.
 Roof lights as dimensions, installed to manufacturers instructions.
 Up stand of 200mm.
 Roof light by Vitrol Stylvision
 Type : Sky Vision Flat Roof Skylights
 : U Value of 1.1 max.
 Outer glass 8 mm clear toughened, 16 mm Argon with aluminium spacer, inner glass 8
 mm clear laminated low 'e'.

INTERNAL PARTITIONS
 All partitions to be constructed as follows:
 STUD - Stress graded BS 4978, Strength BS 5248 - Part 2 C16, Frame - 100mm x 50mm
 s/w studs @ 600mm centres, nailed to head & base plates. Double up studs at openings
 & corners & fit metal corner beads. Provide nogging staggered horizontally @ 600mm
 centres. Fully fill partitions with 100mm quilt insulation - min density 10kg/m³ and the
 each side 12mm plywood and 12.5mm plasterboard - min density 10kg/m³ for sound
 insulation (Use MR plasterboard to wet room areas).

ENTRANCE DOOR
 Ensure that entrance door has a level threshold to enable wheelchair access.

ENTRANCE DOORS
 Entrance door to be non-powered type.
 The opening force at the leading edge of the door shall be no greater than
 20N.
 There shall be 300mm unobstructed space to the full side of the door.
 Where door is fitted with a latch, the door control furniture can be operated
 with one hand using a closed fist, e.g. a lever handle.
 All door opening furniture contrasts visually with the surface of the door and
 is not cold to the touch.

MANIFESTATION
 All glazing to entrance door and side glazed windows to have manifestation
 fitted. Manifestation to be fitted between 800-1100mm above first floor level
 and 1400-1600mm above finished floor level.
 Ead type to be agreed with client.

ROLLER SHUTTERS
 To area shown, allow for supplying and installing roller shutters by
 Hag.
 Roller shutter, AluShield Range N3M.
 1. 1750mm wide x 2600mm high (structural dimensions, check and
 Draw 210 volts and 0.5 - 2.5 amps dependent upon the shutter size
 counter. Call on site before ordering).
 Fresh or cooler shutter and box size - Polyester powder coat (colour
 to be confirmed).

Spring loaded
 A counter balanced spring ensures controlled raising and lowering
 shutter for security.
 with a key lock in-built at the bottom of the
 shutter for security.

Single Phase Electric
 A tubular motor within the barrel assembly with limit switches and
 thermal cut out to prevent overheating.
 Draw 240 volts and 0.5 - 2.5 amps dependent upon the shutter size
 Provision of a 13 amp fused spur is required for installation
Override
 A manual override is included to operate the shutter in the event of
 a power failure. This is usually only Operate
 Control only side.

Standard security key switch or roller switch.
 web: www.hag.co.uk
 Tel: 0800 072 3444
 email: info@hag.co.uk

PART L - SBEM Calculation & EPC
 To Comply with Current Building Regulations, an as designed
 SBEM calculation has been carried out as follows:
 Air Pressure Test result to be less than 2 mhy/hr @ 50 Pascals

ROLLER SHUTTERS
 To area shown, allow for supplying and installing roller shutters by
 Hag.
 Roller shutter, AluShield Range N3M.
 1. 1750mm wide x 2600mm high (structural dimensions, check and
 Draw 210 volts and 0.5 - 2.5 amps dependent upon the shutter size
 counter. Call on site before ordering).
 Fresh or cooler shutter and box size - Polyester powder coat (colour
 to be confirmed).

ROLLER SHUTTERS
 To area shown, allow for supplying and installing roller shutters by
 Hag.
 Roller shutter, AluShield Range N3M.
 1. 1750mm wide x 2600mm high (structural dimensions, check and
 Draw 210 volts and 0.5 - 2.5 amps dependent upon the shutter size
 counter. Call on site before ordering).
 Fresh or cooler shutter and box size - Polyester powder coat (colour
 to be confirmed).

ROLLER SHUTTERS
 To area shown, allow for supplying and installing roller shutters by
 Hag.
 Roller shutter, AluShield Range N3M.
 1. 1750mm wide x 2600mm high (structural dimensions, check and
 Draw 210 volts and 0.5 - 2.5 amps dependent upon the shutter size
 counter. Call on site before ordering).
 Fresh or cooler shutter and box size - Polyester powder coat (colour
 to be confirmed).

ROLLER SHUTTERS
 To area shown, allow for supplying and installing roller shutters by
 Hag.
 Roller shutter, AluShield Range N3M.
 1. 1750mm wide x 2600mm high (structural dimensions, check and
 Draw 210 volts and 0.5 - 2.5 amps dependent upon the shutter size
 counter. Call on site before ordering).
 Fresh or cooler shutter and box size - Polyester powder coat (colour
 to be confirmed).

ROLLER SHUTTERS
 To area shown, allow for supplying and installing roller shutters by
 Hag.
 Roller shutter, AluShield Range N3M.
 1. 1750mm wide x 2600mm high (structural dimensions, check and
 Draw 210 volts and 0.5 - 2.5 amps dependent upon the shutter size
 counter. Call on site before ordering).
 Fresh or cooler shutter and box size - Polyester powder coat (colour
 to be confirmed).

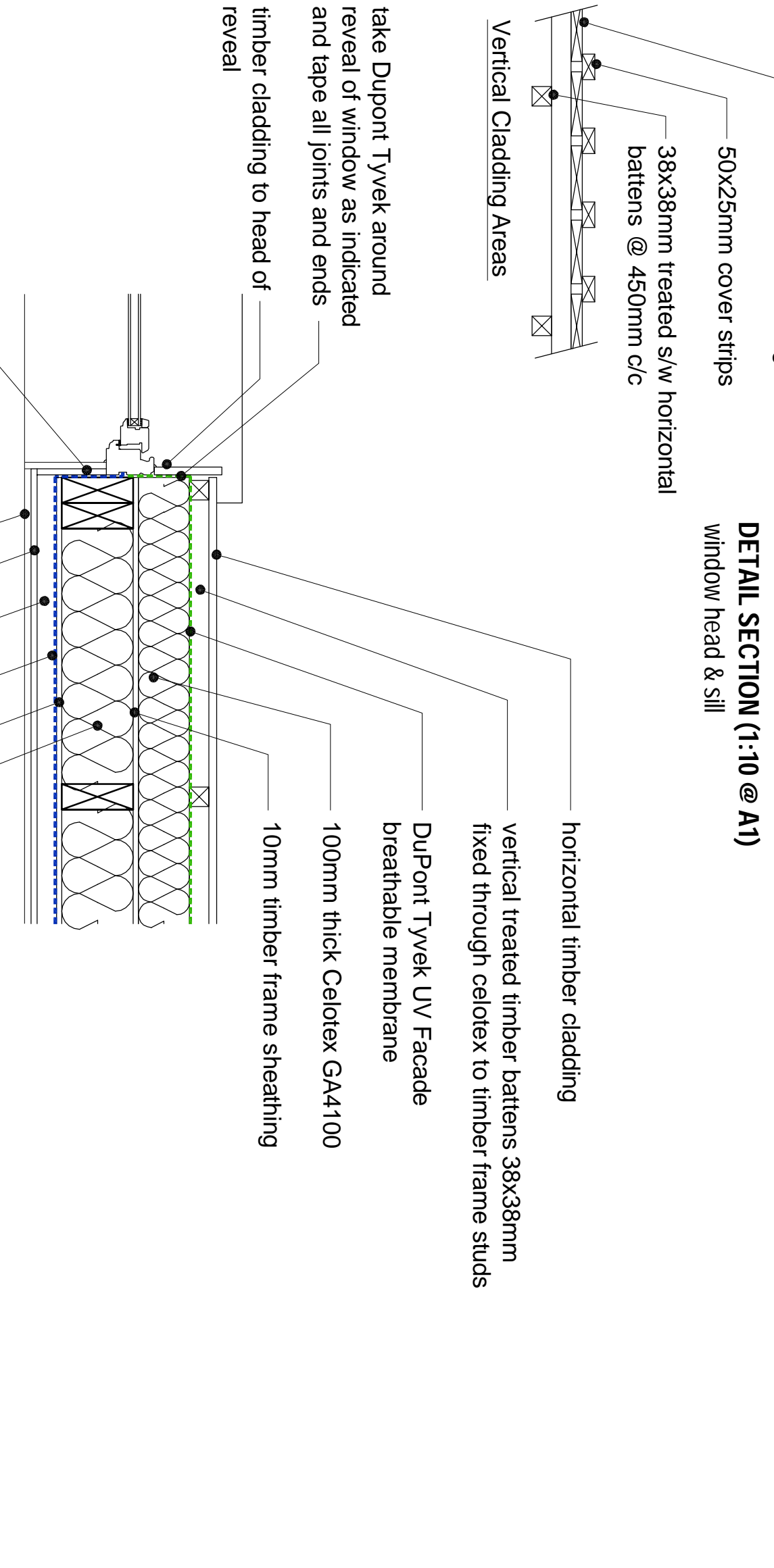
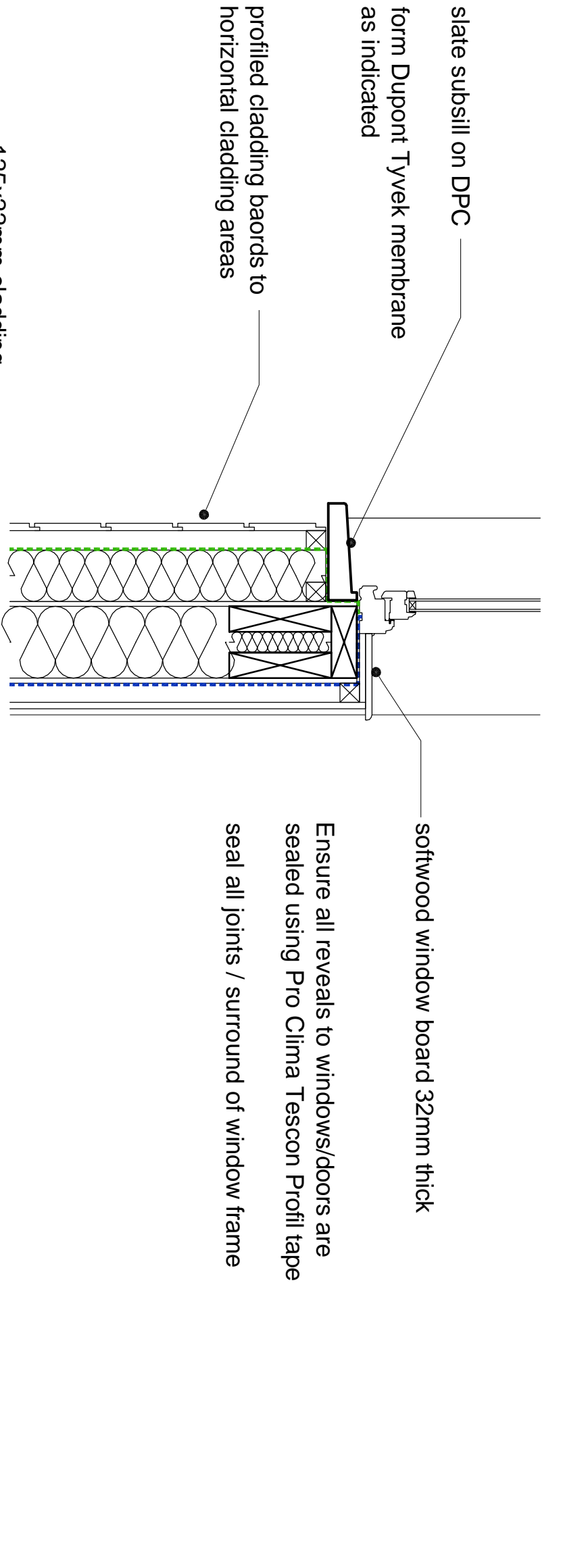
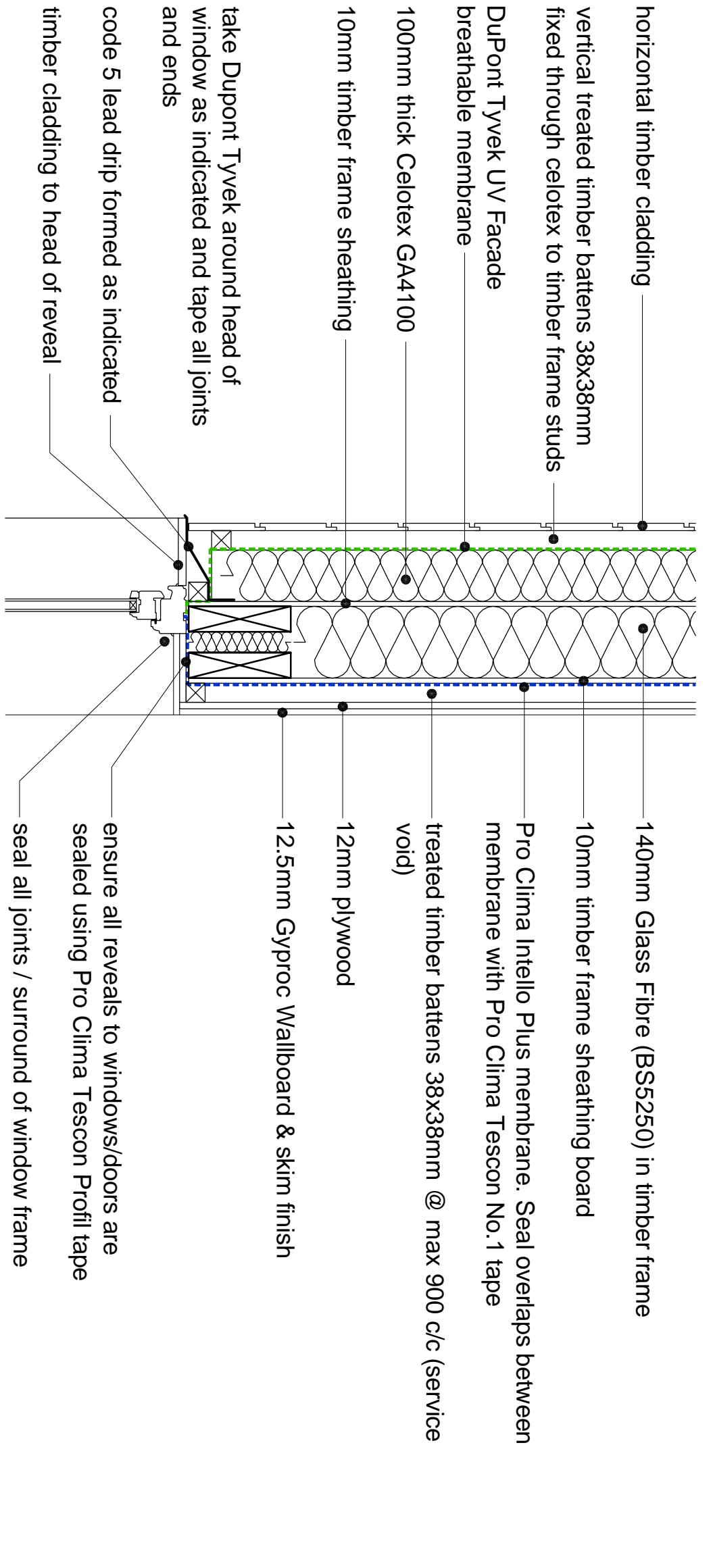

horizontal timber cladding
 vertical treated timber battens 38x38mm
 fixed through celotex to timber frame studs
 DuPont Tyvek UV Facade
 breathable membrane
 100mm thick Celotex G44100
 10mm timber frame sheathing
 12mm plywood
 12.5mm Gyproc Wallboard & Skim finish
 140mm Glass Fibre (BS5250) in timber frame
 10mm timber frame sheathing board
 Pro Clima Intello Plus membrane. Seal overlaps between
 membrane with Pro Clima Tescon No.1 tape
 treated timber battens 38x38mm @ max 900 c/c (service
 void)
 12mm plywood
 12.5mm Gyproc Wallboard & skim finish

horizontal timber cladding
 vertical treated timber battens 38x38mm
 fixed through celotex to timber frame studs
 DuPont Tyvek UV Facade
 breathable membrane
 100mm thick Celotex G44100
 10mm timber frame sheathing
 12mm plywood
 12.5mm Gyproc Wallboard & Skim finish

horizontal timber cladding
 vertical treated timber battens 38x38mm
 fixed through celotex to timber frame studs
 DuPont Tyvek UV Facade
 breathable membrane
 100mm thick Celotex G44100
 10mm timber frame sheathing
 12mm plywood
 12.5mm Gyproc Wallboard & Skim finish

horizontal timber cladding
 vertical treated timber battens 38x38mm
 fixed through celotex to timber frame studs
 DuPont Tyvek UV Facade
 breathable membrane
 100mm thick Celotex G44100
 10mm timber frame sheathing
 12mm plywood
 12.5mm Gyproc Wallboard & Skim finish

horizontal timber cladding
 vertical treated timber battens 38x38mm
 fixed through celotex to timber frame studs
 DuPont Tyvek UV Facade
 breathable membrane
 100mm thick Celotex G44100
 10mm timber frame sheathing
 12mm plywood
 12.5mm Gyproc Wallboard & Skim finish

horizontal timber cladding
 vertical treated timber battens 38x38mm
 fixed through celotex to timber frame studs
 DuPont Tyvek UV Facade
 breathable membrane
 100mm thick Celotex G44100
 10mm timber frame sheathing
 12mm plywood
 12.5mm Gyproc Wallboard & Skim finish

horizontal timber cladding
 vertical treated timber battens 38x38mm
 fixed through celotex to timber frame studs
 DuPont Tyvek UV Facade
 breathable membrane
 100mm thick Celotex G44100
 10mm timber frame sheathing
 12mm plywood
 12.5mm Gyproc Wallboard & Skim finish

horizontal timber cladding
 vertical treated timber battens 38x38mm
 fixed through celotex to timber frame studs
 DuPont Tyvek UV Facade
 breathable membrane
 100mm thick Celotex G44100
 10mm timber frame sheathing
 12mm plywood
 12.5mm Gyproc Wallboard & Skim finish

horizontal timber cladding
 vertical treated timber battens 38x38mm
 fixed through celotex to timber frame studs
 DuPont Tyvek UV Facade
 breathable membrane
 100mm thick Celotex G44100
 10mm timber frame sheathing
 12mm plywood
 12.5mm Gyproc Wallboard & Skim finish

horizontal timber cladding
 vertical treated timber battens 38x38mm
 fixed through celotex to timber frame studs
 DuPont Tyvek UV Facade
 breathable membrane
 100mm thick Celotex G44100
 10mm timber frame sheathing
 12mm plywood
 12.5mm Gyproc Wallboard & Skim finish

horizontal timber cladding
 vertical treated timber battens 38x38mm
 fixed through celotex to timber frame studs
 DuPont Tyvek UV Facade
 breathable membrane
 100mm thick Celotex G44100
 10mm timber frame sheathing
 12mm plywood
 12.5mm Gyproc Wallboard & Skim finish

horizontal timber cladding
 vertical treated timber battens 38x38mm
 fixed through celotex to timber frame studs
 DuPont Tyvek UV Facade
 breathable membrane
 100mm thick Celotex G44100
 10mm timber frame sheathing
 12mm plywood
 12.5mm Gyproc Wallboard & Skim finish

horizontal timber cladding
 vertical treated timber battens 38x38mm
 fixed through celotex to timber frame studs
 DuPont Tyvek UV Facade
 breathable membrane
 100mm thick Celotex G44100
 10mm timber frame sheathing
 12mm plywood
 12.5mm Gyproc Wallboard & Skim finish

horizontal timber cladding
 vertical treated timber battens 38x38mm
 fixed through celotex to timber frame studs
 DuPont Tyvek UV Facade
 breathable membrane
 100mm thick Celotex G44100
 10mm timber frame sheathing
 12mm plywood
 12.5mm Gyproc Wallboard & Skim finish

horizontal timber cladding
 vertical treated timber battens 38x38mm
 fixed through celotex to timber frame studs
 DuPont Tyvek UV Facade
 breathable membrane
 100mm thick Celotex G44100
 10mm timber frame sheathing
 12mm plywood
 12.5mm Gyproc Wallboard & Skim finish

horizontal timber cladding
 vertical treated timber battens 38x38mm
 fixed through celotex to timber frame studs
 DuPont Tyvek UV Facade
 breathable membrane
 100mm thick Celotex G44100
 10mm timber frame sheathing
 12mm plywood
 12.5mm Gyproc Wallboard & Skim finish

horizontal timber cladding
 vertical treated timber battens 38x38mm
 fixed through celotex to timber frame studs
 DuPont Tyvek UV Facade
 breathable membrane
 100mm thick Celotex G44100
 10mm timber frame sheathing
 12mm plywood
 12.5mm Gyproc Wallboard & Skim finish

horizontal timber cladding
 vertical treated timber battens 38x38mm
 fixed through celotex to timber frame studs
 DuPont Tyvek UV Facade
 breathable membrane
 100mm thick Celotex G44100
 10mm timber frame sheathing
 12mm plywood
 12.5mm Gyproc Wallboard & Skim finish

horizontal timber cladding
 vertical treated timber battens 38x38mm
 fixed through celotex to timber frame studs
 DuPont Tyvek UV Facade
 breathable membrane
 100mm thick Celotex G44100
 10mm timber frame sheathing
 12mm plywood
 12.5mm Gyproc Wallboard & Skim finish

horizontal timber cladding
 vertical treated timber battens 38x38mm
 fixed through celotex to timber frame studs
 DuPont Tyvek UV Facade
 breathable membrane
 100mm thick Celotex G44100
 10mm timber frame sheathing
 12mm plywood
 12.5mm Gyproc Wallboard & Skim finish

horizontal timber cladding
 vertical treated timber battens 38x38mm
 fixed through celotex to timber frame studs
 DuPont Tyvek UV Facade
 breathable membrane
 100mm thick Celotex G44100
 10mm timber frame sheathing
 12mm plywood
 12.5mm Gyproc Wallboard & Skim finish

horizontal timber cladding
 vertical treated timber battens 38x38mm
 fixed through celotex to timber frame studs
 DuPont Tyvek UV Facade
 breathable membrane
 100mm thick Celotex G44100
 10mm timber frame sheathing
 12mm plywood
 12.5mm Gyproc Wallboard & Skim finish

horizontal timber cladding
 vertical treated timber battens 38x38mm
 fixed through celotex to timber frame studs
 DuPont Tyvek UV Facade
 breathable membrane
 100mm thick Celotex G44100
 10mm timber frame sheathing
 12mm plywood
 12.5mm Gyproc Wallboard & Skim finish

horizontal timber cladding
 vertical treated timber battens 38x38mm
 fixed through celotex to timber frame studs
 DuPont Tyvek UV Facade
 breathable membrane
 100mm thick Celotex G44100
 10mm timber frame sheathing
 12mm plywood
 12.5mm Gyproc Wallboard & Skim finish

horizontal timber cladding
 vertical treated timber battens 38x38mm
 fixed through celotex to timber frame studs
 DuPont Tyvek UV Facade
 breathable membrane
 100mm thick Celotex G44100
 10mm timber frame sheathing
 12mm plywood
 12.5mm Gyproc Wallboard & Skim finish

horizontal timber cladding
 vertical treated timber battens 38x38mm
 fixed through celotex to timber frame studs
 DuPont Tyvek UV Facade
 breathable membrane
 100mm thick Celotex G44100
 10mm timber frame sheathing
 12mm plywood
 12.5mm Gyproc Wallboard & Skim finish

horizontal timber cladding
 vertical treated timber battens 38x38mm
 fixed through celotex to timber frame studs
 DuPont Tyvek UV Facade
 breathable membrane
 100mm thick Celotex G44100
 10mm timber frame sheathing
 12mm plywood
 12.5mm Gyproc Wallboard & Skim finish

horizontal timber cladding
 vertical treated timber battens 38x38mm
 fixed through celotex to timber frame studs
 DuPont Tyvek UV Facade
 breathable membrane
 100mm thick Celotex G44100
 10mm timber frame sheathing
 12mm plywood
 12.5mm Gyproc Wallboard & Skim finish

horizontal timber cladding
 vertical treated timber battens 38x38mm
 fixed through celotex to timber frame studs
 DuPont Tyvek UV Facade
 breathable membrane
 100mm thick Celotex G44100
 10mm timber frame sheathing
 12mm plywood
 12.5mm Gyproc Wallboard & Skim finish

horizontal timber cladding
 vertical treated timber battens 38x38mm
 fixed through celotex to timber frame studs
 DuPont Tyvek UV Facade
 breathable membrane
 100mm thick Celotex G44100
 10mm timber frame sheathing
 12mm plywood
 12.5mm Gyproc Wallboard & Skim finish

horizontal timber cladding
 vertical treated timber battens 38x38mm
 fixed through celotex to timber frame studs
 DuPont Tyvek UV Facade
 breathable membrane
 100mm thick Celotex G44100
 10mm timber frame sheathing
 12mm plywood
 12.5mm Gyproc Wallboard & Skim finish

horizontal timber cladding
 vertical treated timber battens 38x38mm
 fixed through celotex to timber frame studs
 DuPont Tyvek UV Facade
 breathable membrane
 100mm thick Celotex G44100
 10mm timber frame sheathing
 12mm plywood
 12.5mm Gyproc Wallboard & Skim finish

horizontal timber cladding
 vertical treated timber battens 38x38mm
 fixed through celotex to timber frame studs
 DuPont Tyvek UV Facade
 breathable membrane
 100mm thick Celotex G44100
 10mm timber frame sheathing
 12mm plywood
 12.5mm Gyproc Wallboard & Skim finish

horizontal timber cladding
 vertical treated timber battens 38x38mm
 fixed through celotex to timber frame studs
 DuPont Tyvek UV Facade
 breathable membrane
 100mm thick Celotex G44100
 10mm timber frame sheathing
 12mm plywood
 12.5mm Gyproc Wallboard & Skim finish

horizontal timber cladding
 vertical treated timber battens 38x38mm
 fixed through celotex to timber frame studs
 DuPont Tyvek UV Facade
 breathable membrane
 100mm thick Celotex G44100
 10mm timber frame sheathing
 12mm plywood
 12.5mm Gyproc Wallboard & Skim finish

horizontal timber cladding
 vertical treated timber battens 38x38mm
 fixed through celotex to timber frame studs
 DuPont Tyvek UV Facade
 breathable membrane
 100mm thick Celotex G44100
 10mm timber frame sheathing
 12mm plywood
 12.5mm Gyproc Wallboard & Skim finish

horizontal timber cladding
 vertical treated timber battens 38x38mm
 fixed through celotex to timber frame studs
 DuPont Tyvek UV Facade
 breathable membrane
 100mm thick Celotex G44100
 10mm timber frame sheathing
 12mm plywood
 12.5mm Gyproc Wallboard & Skim finish

horizontal timber cladding
 vertical treated timber battens 38x38mm
 fixed through celotex to timber frame studs
 DuPont Tyvek UV Facade
 breathable membrane
 100mm thick Celotex G44100
 10mm timber frame sheathing
 12mm plywood
 12.5mm Gyproc Wallboard & Skim finish

horizontal timber cladding
 vertical treated timber battens 38x38mm
 fixed through celotex to timber frame studs
 DuPont Tyvek UV Facade
 breathable membrane
 100mm thick Celotex G44100
 10mm timber frame sheathing
 12mm plywood
 12.5mm Gyproc Wallboard & Skim finish

horizontal timber cladding
 vertical treated timber battens 38x38mm
 fixed through celotex to timber frame studs
 DuPont Tyvek UV Facade
 breathable membrane
 100mm thick Celotex G44100
 10mm timber frame sheathing
 12mm plywood
 12.5mm Gyproc Wallboard & Skim finish

horizontal timber cladding
 vertical treated timber battens 38x38mm
 fixed through celotex to timber frame studs
 DuPont Tyvek UV Facade
 breathable membrane
 100mm thick Celotex G44100
 10mm timber frame sheathing
 12mm plywood
 12.5mm Gyproc Wallboard & Skim finish

horizontal timber cladding
 vertical treated timber battens 38x38mm
 fixed through celotex to timber frame studs
 DuPont Tyvek UV Facade
 breathable membrane
 100mm thick Celotex G44100
 10mm timber frame sheathing
 12mm plywood
 12.5mm Gyproc Wallboard & Skim finish

horizontal timber cladding
 vertical treated timber battens 38x38mm
 fixed through celotex to timber frame studs
 DuPont Tyvek UV Facade
 breathable membrane
 100mm thick Celotex G44100
 10mm timber frame sheathing
 12mm plywood
 12.5mm Gyproc Wallboard & Skim finish

horizontal timber cladding
 vertical treated timber battens 38x38mm
 fixed through celotex to timber frame studs
 DuPont Tyvek UV Facade
 breathable membrane
 100mm thick Celotex G44100
 10mm timber frame sheathing
 12mm plywood
 12.5mm Gyproc Wallboard & Skim finish

horizontal timber cladding
 vertical treated timber battens 38x38mm
 fixed through celotex to timber frame studs
 DuPont Tyvek UV Facade
 breathable membrane
 100mm thick Celotex G44100
 10mm timber frame sheathing
 12mm plywood
 12.5mm Gyproc Wallboard & Skim finish

horizontal timber cladding
 vertical treated timber battens 38x38mm
 fixed through celotex to timber frame studs
 DuPont Tyvek UV Facade
 breathable membrane
 100mm thick Celotex G44100
 10mm timber frame sheathing
 12mm plywood
 12.5mm Gyproc Wallboard & Skim finish

horizontal timber cladding
 vertical treated timber battens 38x38mm
 fixed through celotex to timber frame studs
 DuPont Tyvek UV Facade
 breathable membrane
 100mm thick Celotex G44100
 10mm timber frame sheathing
 12mm plywood
 12.5mm Gyproc Wallboard & Skim finish

horizontal timber cladding
 vertical treated timber battens 38x38mm
 fixed through celotex to timber frame studs
 DuPont Tyvek UV Facade
 breathable membrane
 100mm thick Celotex G44100
 10mm timber frame sheathing
 12mm plywood
 12.5mm Gyproc Wallboard & Skim finish

horizontal timber cladding
 vertical treated timber battens 38x38mm
 fixed through celotex to timber frame studs
 DuPont Tyvek UV Facade
 breathable membrane
 100mm thick Celotex G44100
 10mm timber frame sheathing
 12mm plywood
 12.5mm Gyproc Wallboard & Skim finish

horizontal timber cladding
 vertical treated timber battens 38x38mm
 fixed through celotex to timber frame studs
 DuPont Tyvek UV Facade
 breathable membrane
 100mm thick Celotex G44100
 10mm timber frame sheathing
 12mm plywood
 12.5mm Gyproc Wallboard & Skim finish

horizontal timber cladding
 vertical treated timber battens 38x38mm
 fixed through celotex to timber frame studs
 DuPont Tyvek UV Facade
 breathable membrane
 100mm thick Celotex G44100
 10mm timber frame sheathing
 12mm plywood
 12.5mm Gyproc Wallboard & Skim finish

horizontal timber cladding
 vertical treated timber battens 38x38mm
 fixed through celotex to timber frame studs
 DuPont Tyvek UV Facade
 breathable membrane
 100mm thick Celotex G44100
 10mm timber frame sheathing
 12mm plywood
 12.5mm Gyproc Wallboard & Skim finish

horizontal timber cladding
 vertical treated timber battens 38x38mm
 fixed through celotex to timber frame studs
 DuPont Tyvek UV Facade
 breathable membrane
 100mm thick Celotex G44100
 10mm timber frame sheathing
 12mm plywood
 12.5mm Gyproc Wallboard & Skim finish

horizontal timber cladding
 vertical treated timber battens 38x38mm
 fixed through celotex to timber frame studs
 DuPont Tyvek UV Facade
 breathable membrane
 100mm thick Celotex G44100
 10mm timber frame sheathing
 12mm plywood
 12.5mm Gyproc Wallboard & Skim finish

horizontal timber cladding
 vertical treated timber battens 38x38mm
 fixed through celotex to timber frame studs
 DuPont Tyvek UV Facade
 breathable membrane
 100mm thick Celotex G44100
 10mm timber frame sheathing
 12mm plywood
 12.5mm Gyproc Wallboard & Skim finish

horizontal timber cladding
 vertical treated timber battens 38x38mm
 fixed through celotex to timber frame studs
 DuPont Tyvek UV Facade
 breathable membrane
 100mm thick Celotex G44100
 10mm timber frame sheathing
 12mm plywood
 12.5mm Gyproc Wallboard & Skim finish

horizontal timber cladding
 vertical treated timber battens 38x38mm
 fixed through celotex to timber frame studs
 DuPont Tyvek UV Facade
 breathable membrane
 100mm thick Celotex G44100
 10mm timber frame sheathing
 12mm plywood
 12.5mm Gyproc Wallboard & Skim finish

horizontal timber cladding
 vertical treated timber battens 38x38mm
 fixed through celotex to timber frame studs
 DuPont Tyvek UV Facade
 breathable membrane
 100mm thick Celotex G44100
 10mm timber frame sheathing
 12mm plywood
 12.5mm Gyproc Wallboard & Skim finish

horizontal timber cladding
 vertical treated timber battens 38x38mm
 fixed through celotex to timber frame studs
 DuPont Tyvek UV Facade
 breathable membrane
 100mm thick Celotex G44100
 10mm timber frame sheathing
 12mm plywood
 12.5mm Gyproc Wallboard & Skim finish

horizontal timber cladding
 vertical treated timber battens 38x38mm
 fixed through celotex to timber frame studs
 DuPont Tyvek UV Facade
 breathable membrane
 100mm thick Celotex G44100
 10mm timber frame sheathing
 12mm plywood
 12.5mm Gyproc Wallboard & Skim finish

horizontal timber cladding
 vertical treated timber battens 38x38mm
 fixed through celotex to timber frame studs
 DuPont Tyvek UV Facade
 breathable membrane
 100mm thick Celotex G44100
 10mm timber frame sheathing
 12mm plywood
 12.5mm Gyproc Wallboard & Skim finish

horizontal timber cladding
 vertical treated timber battens 38x38mm
 fixed through celotex to timber frame studs
 DuPont Tyvek UV Facade
 breathable membrane
 100mm thick Celotex G44100
 10mm timber frame sheathing
 12mm plywood
 12.5mm Gyproc Wallboard & Skim finish

horizontal timber cladding
 vertical treated timber battens 38x38mm
 fixed through celotex to timber frame studs
 DuPont Tyvek UV Facade
 breathable membrane
 100mm thick Celotex G44100
 10mm timber frame sheathing
 12mm plywood
 12.5mm Gyproc Wallboard & Skim finish

horizontal timber cladding
 vertical treated timber battens 38x38mm
 fixed through celotex to timber frame studs
 DuPont Tyvek UV Facade
 breathable membrane
 100mm thick Celotex G44100
 10mm timber frame sheathing
 12mm plywood
 12.5mm Gyproc Wallboard & Skim finish

horizontal timber cladding
 vertical treated timber battens 38x38mm
 fixed through celotex to timber frame studs
 DuPont Tyvek UV Facade
 breathable membrane
 100mm thick Celotex G44100
 10mm timber frame sheathing
 12mm plywood
 12.5mm Gyproc Wallboard & Skim finish

horizontal timber cladding
 vertical treated timber battens 38x38mm
 fixed through celotex to timber frame studs
 DuPont Tyvek UV Facade
 breathable membrane
 100mm thick Celotex G44100
 10mm timber frame sheathing
 12mm plywood
 12.5mm Gyproc Wallboard & Skim finish

horizontal timber cladding
 vertical treated timber battens 38x38mm
 fixed through celotex to timber frame studs
 DuPont Tyvek UV Facade
 breathable membrane
 100mm thick Celotex G44100
 10mm timber frame sheathing
 12mm plywood
 12.5mm Gyproc Wallboard & Skim finish

horizontal timber cladding
 vertical treated timber battens 38x38mm
 fixed through celotex to timber frame studs
 DuPont Tyvek UV Facade
 breathable membrane
 100mm thick Celotex G44100
 10mm timber frame sheathing
 12mm plywood
 12.5mm Gyproc Wallboard & Skim finish

horizontal timber cladding
 vertical treated timber battens 38x38mm
 fixed through celotex to timber frame studs
 DuPont Tyvek UV Facade
 breathable membrane
 10